

# BRIZO<sup>®</sup>

## ACCESSORIES

- Vesi™ Series
- Double Light

Submitted Model No.: \_\_\_\_\_

Specific Features: \_\_\_\_\_

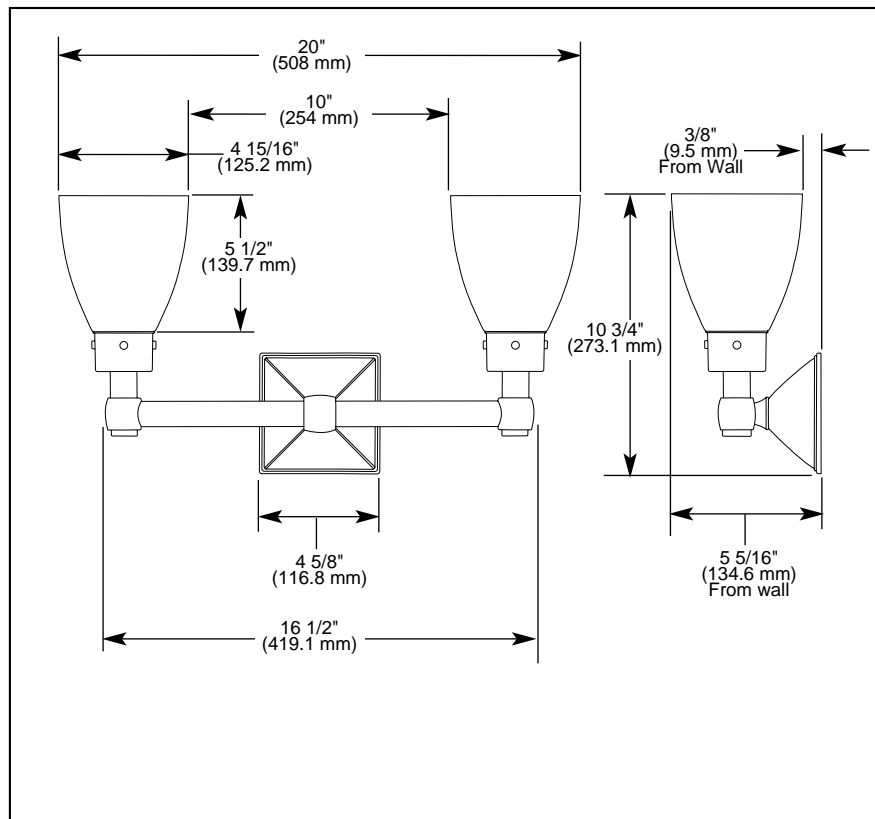

### STANDARD SPECIFICATIONS:

- Mounting hardware and mounting instructions included with product.
- Glass dome is satin etched.
- UL approved up to 100 watts.
- Light fixture can be used either facing up or down.
- Mounts on standard electrical box.

### WARRANTY

- Lifetime Faucet and Finish Limited Warranty to the original consumer purchaser to be free from defects in material and workmanship.
- 5 Year Limited Warranty for usage in all industrial, commercial and business applications.